

PARK CENTRAL HOTEL SAN FRANCISCO

THIRD LEVEL BALLROOM

floorplan

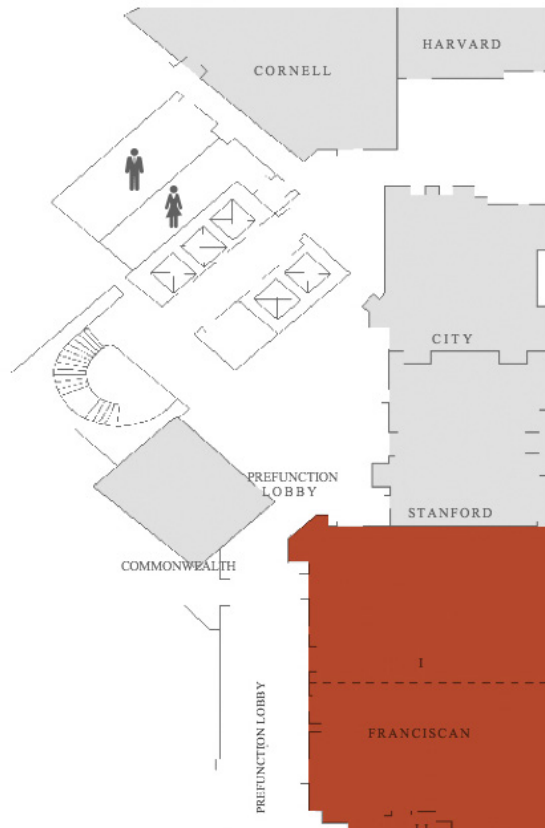

THIRD LEVEL BALLROOM

THIRD LEVEL BALLROOM SPECS & CAPACITY CHART

ROOM NAME	TOTAL SQ. FEET	DIMENSIONS	CEILING	BANQUET	THEATER	CONFERENCE	RECEPTION	CLASSROOM	U-SHAPE	HOLLOW SQUARE	DINNER DANCE
FRANCISCAN I	1,748	46' X 38'	10'	112	112	50	112	90	40	44	70
FRANCISCAN II	1,196	46' X 26'	10'	50	79	34	79	45	30	34	—
FRANCISCAN BALLROOM	2,944	64' X 46'	10'	190	191	84	191	150	40	45	120