

# PARK CENTRAL HOTEL SAN FRANCISCO

## SECOND LEVEL BALLROOM

*floorplan*

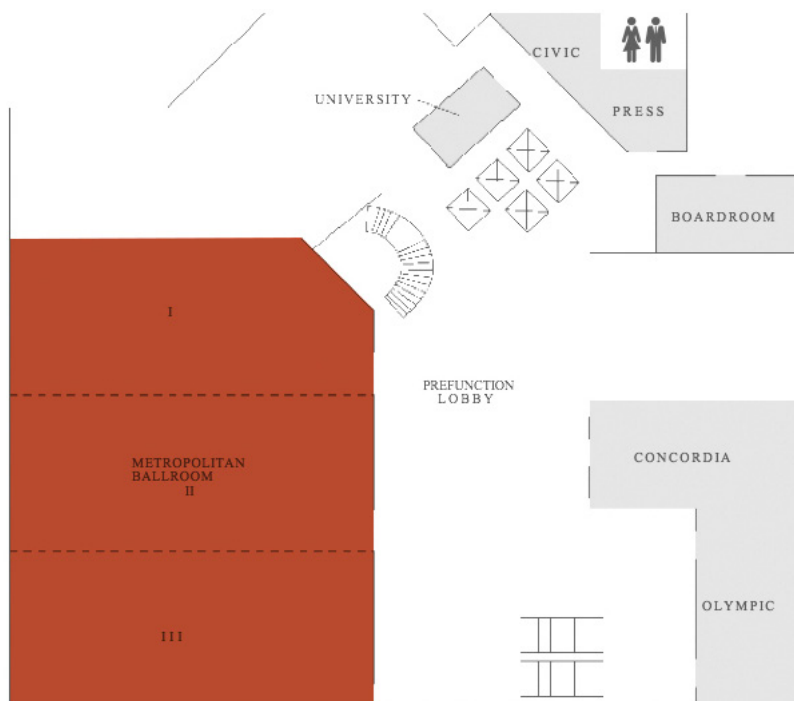

## SECOND LEVEL BALLROOM SPECS & CAPACITY CHART

ROOM NAME	TOTAL SQ. FEET	DIMENSIONS	CEILING	BANQUET	THEATER	CONFERENCE	RECEPTION	CLASSROOM	U-SHAPE	HOLLOW SQUARE	DINNER DANCE
METROPOLITAN I	2,720	80' X 34'	16'	200	300	60	384	165	50	56	140
METROPOLITAN II	3,040	80' X 38'	16'	260	360	60	442	225	60	68	200
METROPOLITAN III	3,280	80' X 41'	16'	216	216	60	216	216	60	68	230
METROPOLITAN BALLROOM	9,040	80' X 114'	16'	760	1,042	194	1,042	640	225	230	600