

PARK CENTRAL HOTEL SAN FRANCISCO

THIRD LEVEL EVENT SPACE

floorplan

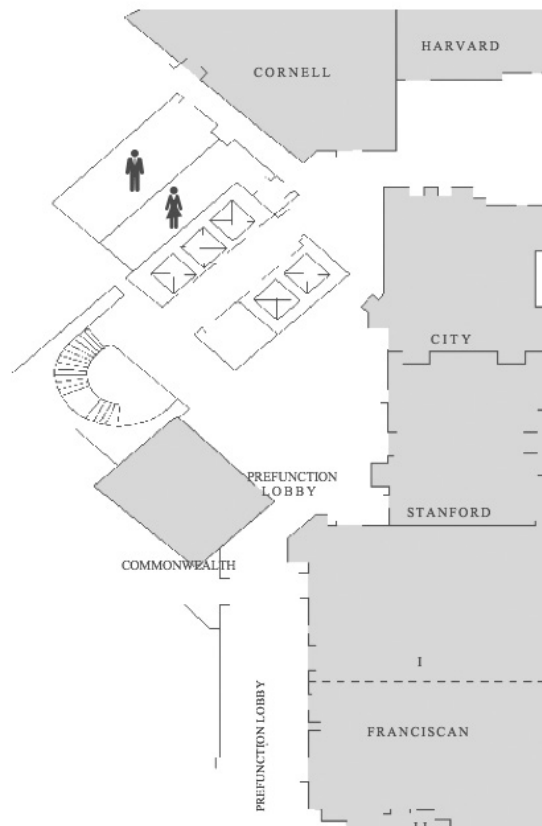

THIRD LEVEL EVENT SPACE

PARK CENTRAL HOTEL

SAN FRANCISCO

EVENT SPACE SPECS & CAPACITY CHART

ROOM NAME	TOTAL SQ. FEET	DIMENSIONS	CEILING	BANQUET	THEATER	CONFERENCE	RECEPTION	CLASSROOM	U-SHAPE	HOLLOW SQUARE	DINNER DANCE
FRANCISCAN I	1,748	46' X 38'	10'	112	112	50	112	90	40	44	70
FRANCISCAN II	1,196	46' X 26'	10'	50	79	34	79	45	30	34	—
FRANCISCAN BALL-ROOM	2,944	64' X 46'	10'	190	191	84	191	150	40	45	120
CITY	992	32' X 31'	10'	60	65	30	65	50	32	36	40
STANFORD	1,050	35' X 30'	10'	60	70	30	70	50	32	34	40
COMMONWEALTH	546	26' X 21'	10'	30	38	24	38	30	20	24	—
CORNELL	1,184	37' X 32'	10'	60	77	30	77	36	30	34	—
HARVARD	420	28' X 15'	10'	—	—	12	—	—	—	—	—